

aluminium
**SLIDING
DOORS**

ESS 47 Hybrid



ALUNET
SYSTEMS

ESS47 HYBRID SLIDING DOORS

Aluminium sliding doors create a visually stunning addition to your home and can add huge value to the property.

Thermal performance and strong, super slim profile sections to minimise the visible framework and maximise the glass area, is key to the ESS47 Sliding Door's design.

Engineering grade hardware allows for silky smooth opening and closing operation.

What's more, all our doors are rigorously tested to European safety standards and powder coated to Qualicoat's specifications, for complete peace of mind.

Why choose Aluminium?

- ✓ Aluminium is extremely durable and hard-wearing. You'll be able to enjoy your aluminium doors for not only years but decades to come as they're incredibly resistant to the elements.
- ✓ It is an incredibly strong material, providing a high level of security.
- ✓ Aluminium doors are among the best-insulated on the market, thanks to advanced thermal break technology.
- ✓ They require very little maintenance to ensure optimal performance and to keep them looking good as new.



ESS47 Hybrid

ESS 47 Hybrid



**EN
TESTED**
FOR SAFETY

**QUALICOAT
ASSURED
POWDER
COATED**

**ULTRA
SLIM
SIGHTLINES**

ESS47 Hybrid Sliding Doors perfectly frame and enhance the outdoor view while creating a light, bright indoor space in your home. They effectively turn an entire wall into glass with the added freedom of accessibility and seamless connection between the indoors and outdoors.

With a super slim interlock of just 25mm for maximum vision, excellent thermal performance, noise reduction, high security and weatherproofing.

Designed for large spaces, single, double and triple track options are available allowing for a variety of opening configurations.

All our products can be finished in several glazing options to create a style to suit any property. Our sliding door range is available with the following glazing options:

- Double glazed
 - Triple glazed
 - Integral blinds
 - Laminated Glass
- ... and many more.



Hardware and Security

The super slim ESS47 Sliding Door system comes with a range of sleek, complementary hardware. Available in a variety of colours.

Combined with a high-security multipoint locking system, keeping your property safe and secure.



Configurations

The ESS47 Sliding Door system has a variety of opening configurations, depending on how many panes are chosen and which panes you would like sliding or fixed. There is a perfect solution for every project.



Door Colours

Our doors are available in three standard colours, plus two dual colour options.

For projects requiring bespoke coloured doors, any RAL colour can be available upon request.

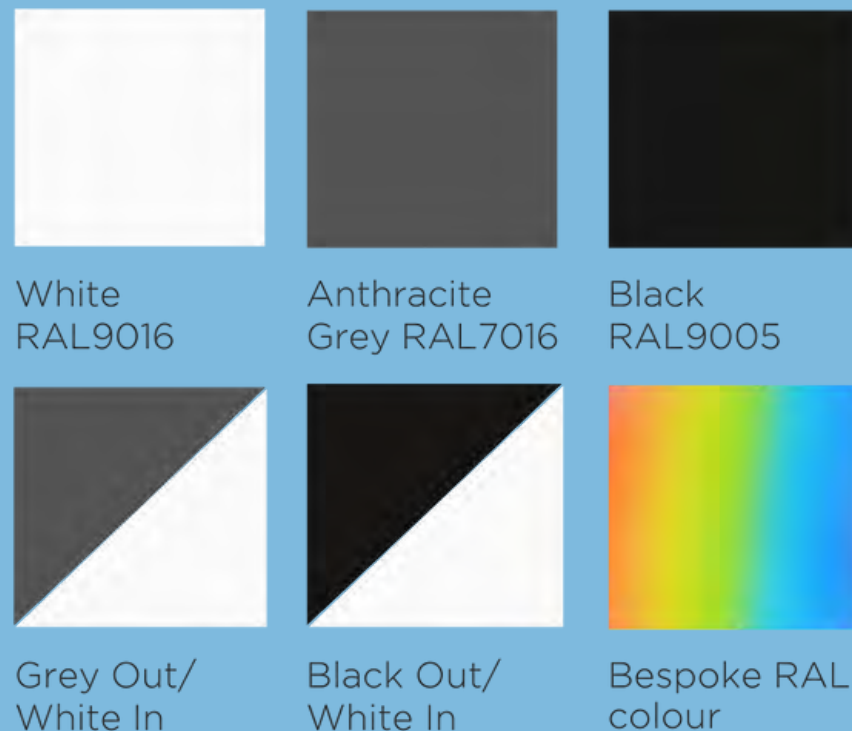

Design Features:

- Super slim 25mm interlock.
- Double and triple track option.
- Double and triple glazing options.
- High security lock.
- Smooth sliding operation.
- Quick and easy to fabricate and install.



Our aluminium products complement our range of aluminium doors and windows and can be designed to coordinate with each other, for the complete look.

They can also be used on their own to make a unique statement.



Bifolding Doors

OTHER PRODUCTS

Our product offering doesn't end with sliding doors. We have a full range of other aluminium home improvement products that cater for any project, any style, and any aperture.

Other products include:

- Windows
- Bifold Doors
- French Doors
- Single Doors



Super slim casement window

Our Aluminium window system features:

- Matching 73mm frame, allowing easy connection to the bifold system if needed.
- Flush frame and sash gives amazing sight-lines.
- Document L compliant with all current regulations.
- Choice of 5 frame and handle colours.
- PAS 24 compliant.



Aluminium French Doors - Heritage Style

SPECIAL FEATURES

- 25mm super slim interlock.
- 250kg max sash weight.
- 2.5 x 2.7m max sash dimension.
- Multiple configuration options.
- Inline slider and lift and slide option. 2 systems in 1.
- Rubber gaskets for better weathering.

Cross Section Double Track

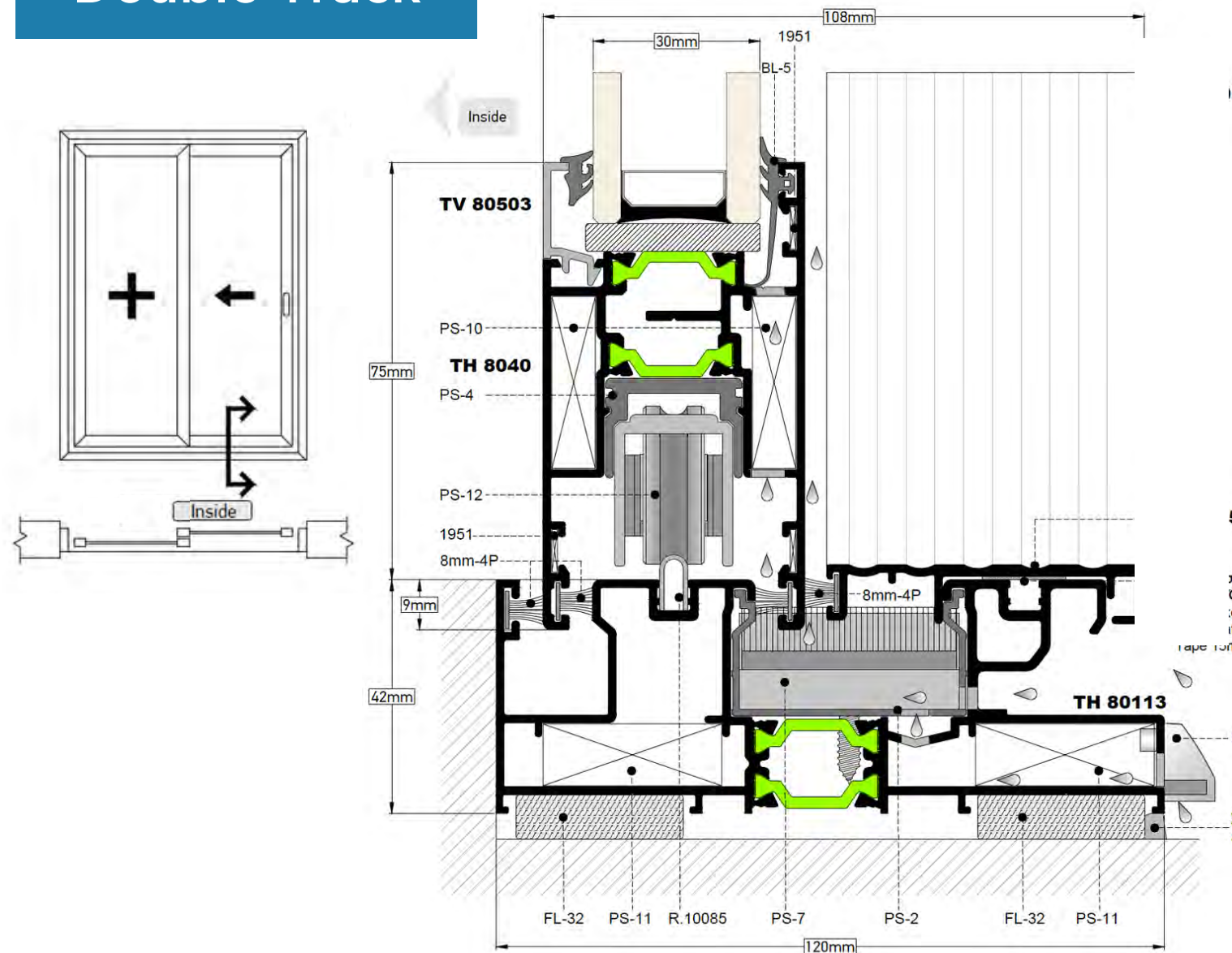

Cross Section Triple Track

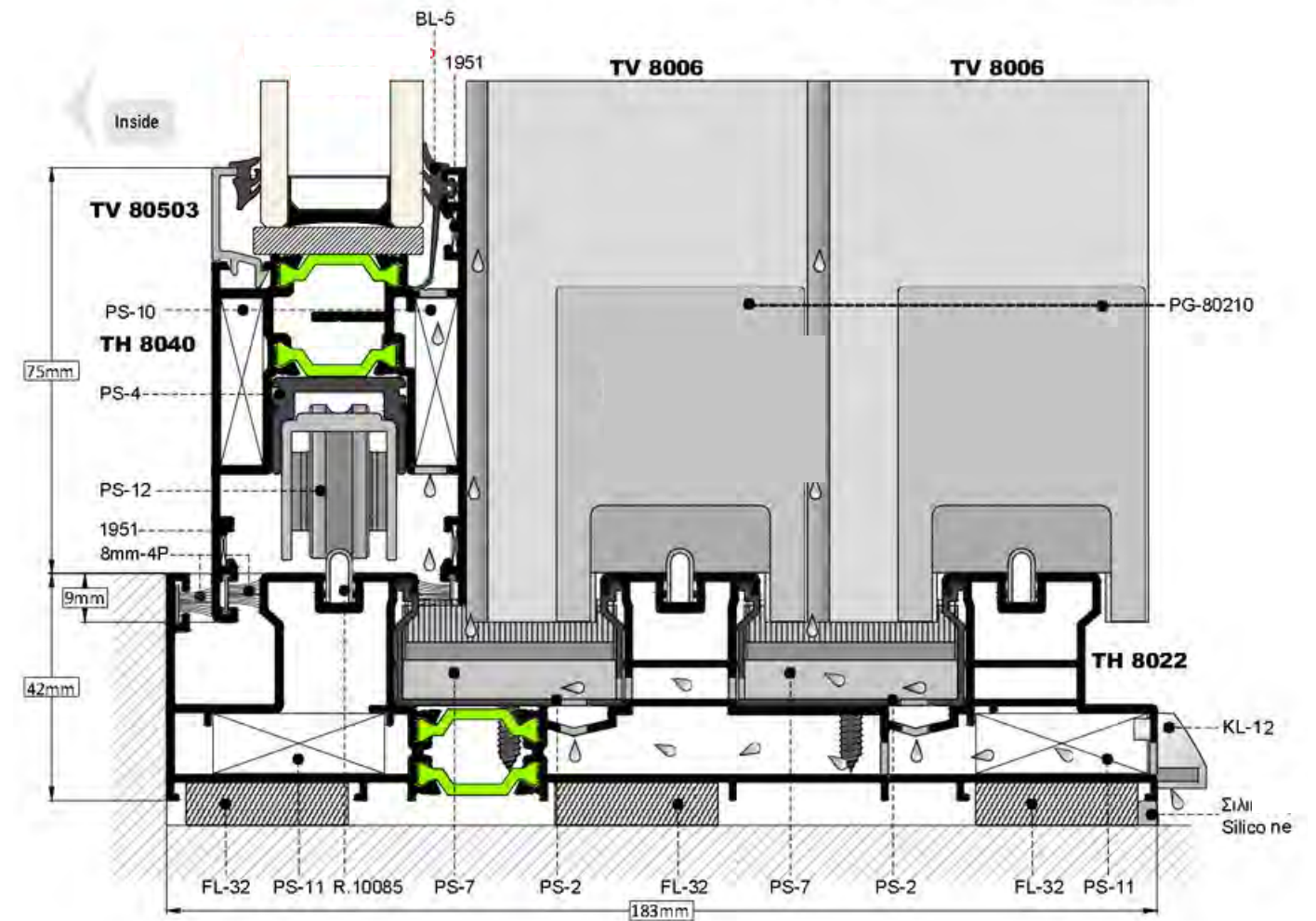
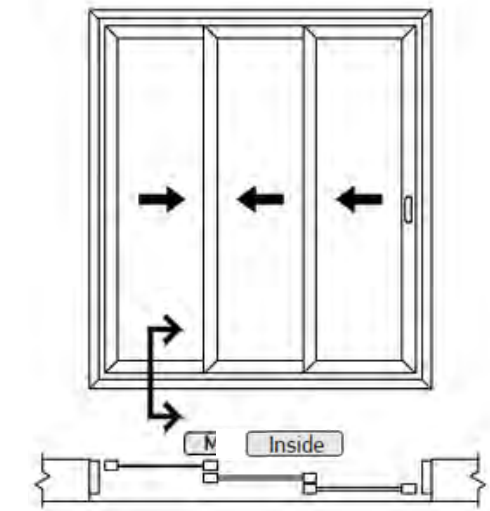

Triple Track

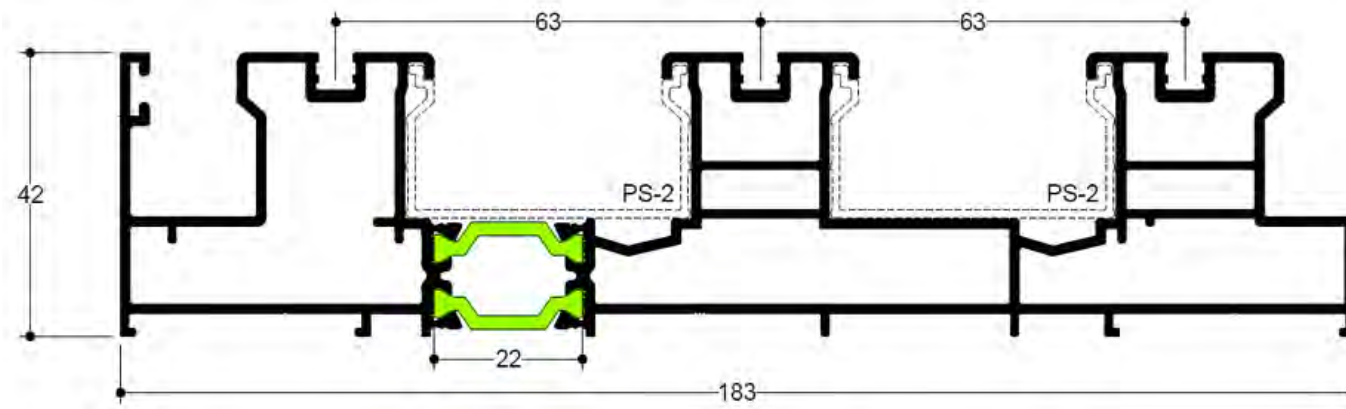

Double Track

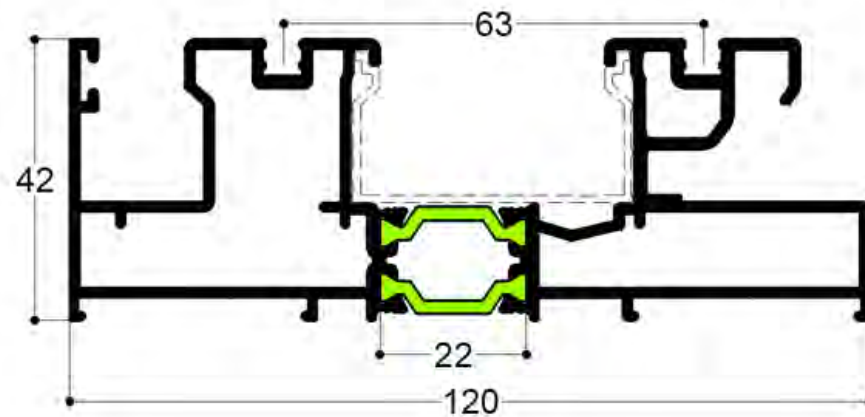

Sash Profile

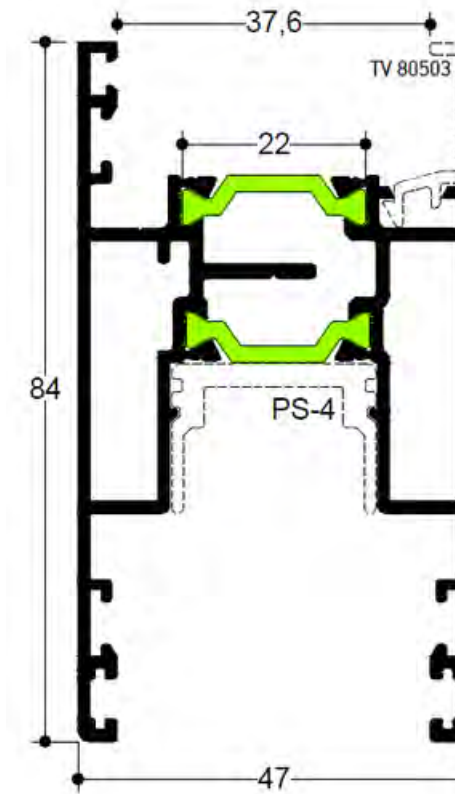

Market-maximum sash size	2.5m x 2.7m
Maximum sash weight per door leaf	250kg
Maximum vision - minimal sightlines	25mm
Double track outer frame width	120mm
Triple track outer frame width	183mm
Maximum security	EN tested to European standards
Maximum insulation U-value	1.5 W/m ² K, DER C rating
Maximum weather-proofing	BS6375 Part 1 : 2009
Single or dual colour	Qualicoat factory powder coated

**SUPER
SLIM
INTERLOCK**

quality

ALUMINIUM SYSTEMS



Scan the QR code to find our social media channels for all the latest news and inspiring installations.

ES 47 Hybrid

ALUNET
SYSTEMS

Tel 01924 350110
Email sales@alunetsystems.co.uk

www.alunetsystems.co.uk

